

### Description

The JSL-I8 is a premium 10.1-inch Linux-based facial recognition door phone designed for smart residential and commercial access control. Featuring Tuya Cloud intercom, multi-method unlocking, integrated security functions, and elevator control compatibility, it delivers both convenience and safety. With a toughened glass and aluminum alloy housing, IK07 explosion-proof rating, and wide temperature range from -40°C to +70°C, the I8 is built for reliable performance in any environment.

### Main Features

- 10.1" Full-color TFT LCD Touch Screen for intuitive operation
- Tuya Cloud Intercom for seamless remote communication
- Multiple unlocking methods: facial recognition, IC/ID card swipe, QR code, Bluetooth, and password
- Integrated night light compensation for clear facial recognition in low light
- Video image preprocessing for improved recognition accuracy
- Human body detection to trigger events automatically
- Anti-hijacking alarm for emergency situations
- Advertisement playback function for community or commercial use
- Lift control and property notice functions for integrated building management
- Easy integration with elevator control systems via TCP/IP protocol
- Durable construction with aluminum alloy frame and toughened glass panel
- IK07 explosion-proof grade for vandal resistance
- Wide operating temperature range for extreme environments



### Specifications

<b>System</b>	Linux
<b>Display</b>	10.1-inch TFT LCD, Touch Screen
<b>Resolution</b>	800 × 1280
<b>Color</b>	Black
<b>Installation</b>	Embedded
<b>Material</b>	Aluminum alloy + Toughened glass
<b>IK Level</b>	IK07
<b>Unlock Methods</b>	Facial recognition, IC/ID card swipe, QR code, Bluetooth, Password
<b>Functions</b>	Tuya Cloud intercom, Lift control, Property notice, Advertisement playback, Night light compensation, Video image preprocessing, Human body detection, Anti-hijack alarm
<b>Protocol</b>	TCP/IP
<b>Power Supply</b>	DC12-24V ±10%
<b>Working Temperature</b>	-40°C ~ +70°C
<b>Storage Temperature</b>	-40°C ~ +70°C
<b>Working Humidity</b>	10~90% RH
<b>Dimensions (mm)</b>	339 × 190 × 35

Appearance and Interfaces

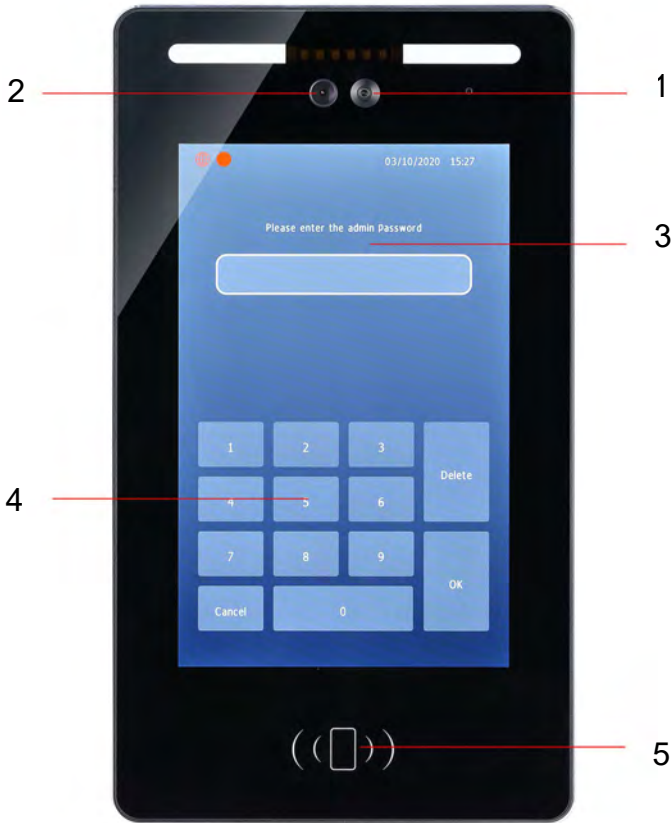

No.		Description
1		Main Camera
2		Auxiliary Camera
3		Display
4		Keyboard
5		Card Reading Area

### Dimension

